

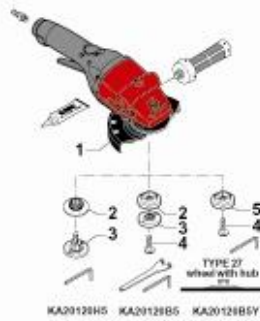

# Accessories

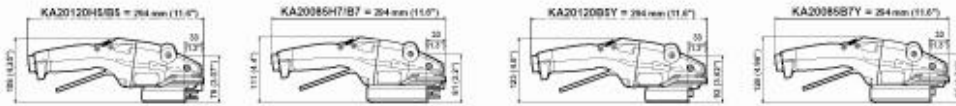

KA20120H5 KA20120B5 KA20120B5Y

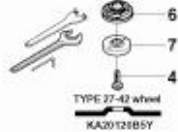

KA20085H7 KA20085B7 KA20085B7Y



KA20085B7Y

## KA20120H5 / KA20120B5 / KA20120B5Y - $\varnothing$ 127mm (5")

### ACCESSORIES INCLUDED

ITEM	KA20120H5 Hex	KA20120B5 5/8" - 11L	KA20120B5Y 5/8" - 11L
• 1/2" air hose nipple for a 13mm (1/2") ID hose	615 704 016 0	615 704 016 0	615 704 016 0
• Vibration-damping side handle	615 576 066 0	615 576 066 0	615 576 066 0
• Oil can (7ml)	615 990 170 0	615 990 170 0	615 990 170 0
1 Guard	615 504 170 0	615 504 170 0	615 504 172 0
2 Rear flange	615 503 152 0	615 503 141 0	-
3 Front flange	615 502 071 0	615 502 067 0	-
4 Safety screw	-	615 614 076 0	615 614 076 0
5 Flange	-	615 614 076 0	615 503 153 0
• Hex. key 6mm	615 802 056 0	615 802 057 0	615 802 057 0
• Pin wrench 35mm (1 1/2")	-	615 802 010 0	-

### OPTIONAL ACCESSORIES

ITEM	KA20120B5Y
6 Rear flange	615 503 143 0
7 Nut	615 502 067 0
4 Safety screw	615 614 076 0
• Hex. Key 6.35mm (1/4")	615 802 057 0
• Pin wrench 35mm (1 1/2")	615 802 010 0
• Flat wrench 27mm (1 1/8")	615 802 077 0

## KA20085H7 / KA20085B7 / KA20085B7Y - $\varnothing$ 180mm (7")

### ACCESSORIES INCLUDED

ITEM	KA20085H7 Hex	KA20085B7 5/8" - 11L	KA20085B7Y 5/8" - 11L
• 1/2" air hose nipple for a 13mm (1/2") ID hose	615 704 016 0	615 704 016 0	615 704 016 0
• Vibration-damping side handle	615 576 066 0	615 576 066 0	615 576 066 0
• Oil can (7ml)	615 990 170 0	615 990 170 0	615 990 170 0
1 Guard	615 504 171 0	615 504 171 0	615 504 173 0
2 Rear flange	615 503 152 0	615 503 141 0	-
3 Front flange	615 502 071 0	615 502 067 0	-
4 Safety screw	-	615 614 076 0	615 614 076 0
5 Flange	-	615 614 076 0	615 503 153 0
• Hex. key 6mm	615 802 056 0	615 802 056 0	615 802 056 0
• Pin wrench 35mm (1 1/2")	-	615 802 010 0	-

### OPTIONAL ACCESSORIES

ITEM	KA20085B7Y
6 Wheel adapter	C087920

### OTHER OPTIONAL ACCESSORIES

ITEM	PART NO.
• Oil can (250ml)	615 990 168 0
• Rotating bushing inlet 1/2"	615 396 366 0



## Grinders for depressed centre wheels, cut-off wheels & flap wheels ø 127mm (5") - ø 180mm (7") 2000 Watts (2.7 hp) - 8500 to 12000 rpm

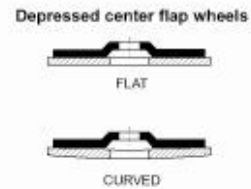
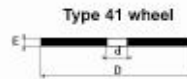
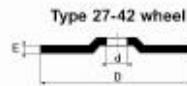
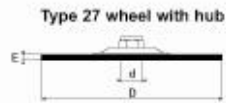

*Caution: comply with the speeds recommended by component and abrasive manufacturers*

PIC REF	MODEL	PART NUMBER	FREE SPEED	WHEEL MAX CAPACITY		SPINDLE TYPE	POWER		WEIGHT				AIR CONSUMPTION		AIR INLET THREAD		HOSE INT. Ø		
				D	E x d		W	hp	kg	lb.	lis	cfm	lis	cfm	inch	mm	in	in	
A	KA20120HS	615 170 288 0	12000	127x6.4x22.2	5x1/8x7/8	HEX	2000	2.7	2.5	5.5	12	25	30	63	1/2	13	1/2		
A	KA20120BS	615 170 301 0	12000	127x6.4x22.2	5x1/8x7/8	5/8"-11L	2000	2.7	2.4	5.3	12	25	30	63	1/2	13	1/2		
B	KA20085H7	615 170 289 0	8500	180x9.5x22.2	7x3/8x7/8	HEX	2000	2.7	2.7	5.9	12	25	30	63	1/2	13	1/2		
B	KA20085B7	615 170 302 0	8500	180x9.5x22.2	7x3/8x7/8	5/8"-11L	2000	2.7	2.6	5.8	12	25	30	63	1/2	13	1/2		
<b>For USA market only (to ANSI B186.1)</b>																			
A	KA20120BSY	615 170 321 0	12000	127x6.4x22.2	5x1/8x22.2	5/8"-11L	2000	2.7	2.4	5.3	12	25	30	63	1/2	13	1/2		
B	KA20085B7Y	615 170 322 0	8500	180x9.5x22.2	7x3/8x7/8	5/8"-11L	2000	2.7	2.6	5.8	12	25	30	63	1/2	13	1/2		



# Grinders for type 1 wheels, cone wheels, depressed centre wheels, cut-off wheels & flap wheels

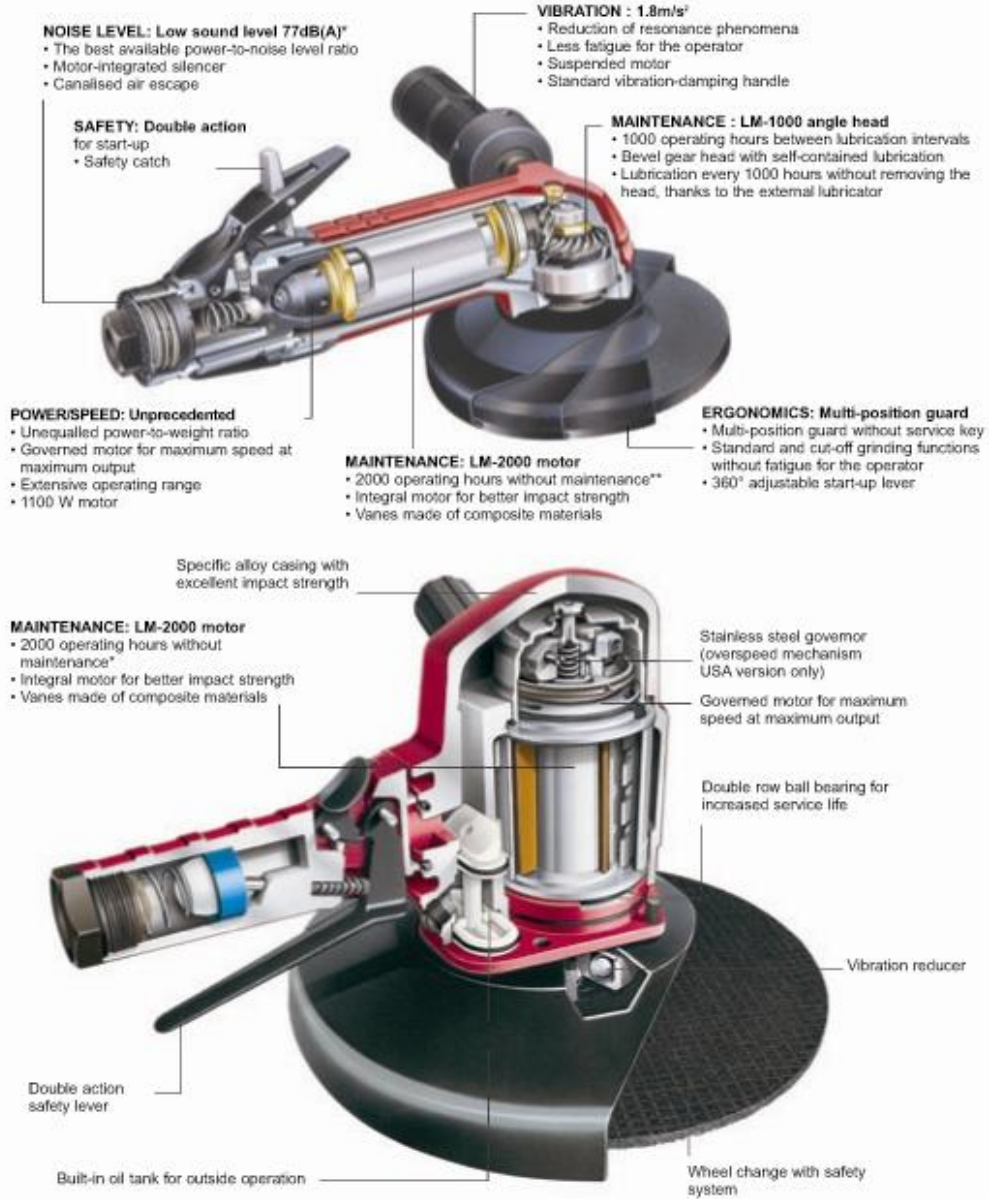

\* With piped away exhaust kit \*\* Subject to use as per the instruction manual supplied with the tool

