



## Dust extraction systems

### for straight grinders

600 - 900 Watts (0.8 - 1.21 hp) - 12000 to 28000 rpm



A



B



B



615 396 014 0  
Vacuum hose  
ID 25 mm  
(1")



615 396 013 0  
Vacuum hose  
ID 32 mm  
(1 1/4")



615 396 023 0  
Vacuum hose  
ID 32 mm  
(1 1/4")

Caution: comply with the speeds recommended by component and abrasive manufacturers

PIC REF	MODEL	PART NUMBER			SUCTION CAP ASSEMBLY	FREE SPEED	POWER		WEIGHT		AIR INLET THREAD
		CNOMO COLLET (-7)	SERIES 200 COLLET (-9)				W	hp	kg	lb.	
A	K628-	615 170 107 0	615 170 150 0	+	615 396 014 0	28000	600	0.80	1.3	2.9	3/8"
A	K624-	615 170 106 0	615 170 151 0	+	615 396 014 0	24000	600	0.80	1.3	2.9	3/8"
A	K922-	615 170 119 0	615 170 152 0	+	615 396 014 0	22000	900	1.21	1.4	3.1	3/8"
A	K619-	615 170 105 0	615 170 153 0	+	615 396 014 0	19000	600	0.80	1.3	2.9	3/8"
A	K918-	615 170 117 0	615 170 154 0	+	615 396 014 0	18000	900	1.21	1.4	3.1	3/8"
A	K615-	615 170 104 0	615 170 155 0	+	615 396 014 0	15000	600	0.80	1.3	2.9	3/8"
A	K915-	615 170 114 0	615 170 156 0	+	615 396 014 0	15000	900	1.21	1.4	3.1	3/8"
A	K912-	615 170 110 0	615 170 157 0	+	615 396 014 0	12000	900	1.21	1.4	3.1	3/8"
B	KC628-	615 170 126 0	615 170 158 0	+	615 396 013 0 or 615 396 023 0	28000	600	0.80	0.9	2.0	3/8"
B	KC624-	615 170 125 0	615 170 159 0	+	615 396 013 0 or 615 396 023 0	24000	600	0.80	0.9	2.0	3/8"
B	KC922-	615 170 130 0	615 170 160 0	+	615 396 013 0 or 615 396 023 0	22000	900	1.21	1.0	2.2	3/8"
B	KC619-	615 170 124 0	615 170 161 0	+	615 396 013 0 or 615 396 023 0	19000	600	0.80	0.9	2.0	3/8"
B	KC918-	615 170 129 0	615 170 162 0	+	615 396 013 0 or 615 396 023 0	18000	900	1.21	1.0	2.2	3/8"
B	KC615-	615 170 123 0	615 170 163 0	+	615 396 013 0 or 615 396 023 0	15000	600	0.80	0.9	2.0	3/8"
B	KC915-	615 170 128 0	615 170 164 0	+	615 396 013 0 or 615 396 023 0	15000	900	1.21	1.0	2.2	3/8"
B	KC912-	615 170 127 0	615 170 165 0	+	615 396 013 0 or 615 396 023 0	12000	900	1.21	1.0	2.2	3/8"



# Accessories

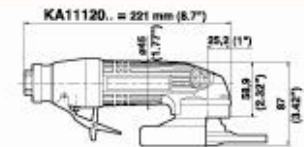

## KA11120.5K / KA11120A. / KA11120B5. / KA11075. / KA11060.

### ACCESSORIES INCLUDED

ITEM	KA11120HSK KA11120A3K	KA11120A4D	KA11120A. KA11120B5. KA110. A / B
• Exhaust hose L= 1.5m (60")	615 675 113 0	615 675 113 0	615 675 113 0
• Clamp	615 673 415 0	615 673 415 0	615 673 415 0
• 1/4" air hose nipple for 13 mm (1/2") ID hose	615 704 027 0	615 704 027 0	615 704 027 0
1 Side handle	615 576 038 0	615 576 038 0	615 576 038 0
2 Vibration-damping side handle	615 576 066 0		
3 Complete silencer kit	615 396 166 0		
4 Thermal insulating sleeve	615 570 412 0		
5 Wheel guard	615 396 076 0		
6 Rear flange	615 503 134 0		
7 Front flange	615 502 066 0		
8 Spacer	615 643 074 0		
• Hex key 8mm (5/16")	615 802 061 0		

### OPTIONAL ACCESSORIES

For grinding or sanding with semirigid disc for metallic materials

ITEM	KA11120A5K KA11120A5.	KA11120HSK KA11120B5.
A Suction cap for grinding wheel & semirigid disc ø 127mm (5")	615 396 009 0	615 396 009 0
9 Push fit hood	615 570 364 0	615 570 364 0
10 Backing pad with nut M14 (max. 12000rpm)*	615 990 129 0	615 990 129 0
• Washer	615 643 076 0	615 643 076 0

For sanding metallic materials

ITEM	KA11120A / B KA110. A / B
B Suction cap for standard abrasive disc ø 127mm (5")	615 396 010 0
11 Ventilated backing pad with nut M14 & 5/8" (max. 12000rpm)	615 990 127 0

For sanding non metallic materials

ITEM	KA11120A / B KA110. A / B
C Suction cap for standard abrasive disc ø 127mm (5")	615 396 012 0
11 Ventilated backing pad with nut M14 & 5/8" (max. 12000rpm)	615 990 127 0
12 Spare brush	615 570 466 0
• Washer	615 643 076 0

### OTHER OPTIONAL ACCESSORIES

ITEM	PART NO.
13 Diamond disc ø 100mm (4") for KA11120A4D	615 860 002 0
14 Complete silencer kit	615 396 166 0
15 Inlet hose assembly L = 1.7 m (67") - 3/8" M - 3.8" F ø 13 mm (1/2")	615 804 064 0
16 Reinforced cloth-lined exhaust hose L = 0.75m (30")	615 675 116 0
2 Vibration-damping side handle	615 576 066 0
4 Thermal insulating sleeve	615 570 412 0
17 Grease gun (capacity 24g - 0.8oz)	615 990 149 0
• Lubricant for bevel gear (1 kg - 2.2 lb)	615 990 148 0

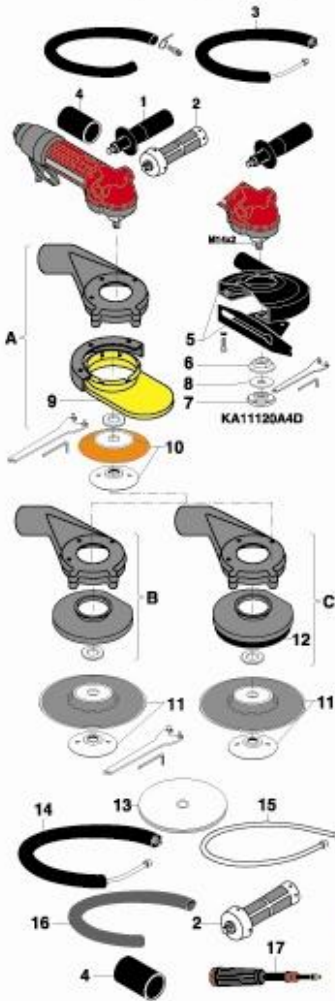

## Dust extraction systems for angle grinders & sanders

ø 100mm (4") - ø 127mm (5")

900 to 1100 Watts (1.21 to 1.5 hp) - 6000 to 12000 rpm



A

Adjustable lever



B

Dust extraction casing for diamond disc ø 100 mm (4")  
Vacuum hose ID 25 mm (1")

Adjustable lever



C

For wheel or  
semirigid  
abrasive disc for  
metallic materials



615 396 009 0  
Vacuum hose  
ID 38mm  
(1 1/2")

Standard  
abrasive disc for  
metallic materials



615 396 010 0  
Vacuum hose  
ID 38mm  
(1 1/2")

Standard  
abrasive disc for  
non metallic  
materials



615 396 012 0  
Vacuum hose  
ID 38mm  
(1 1/2")

Caution: comply with the speeds recommended by component and abrasive manufacturers

PIC REF	MODEL	PART NUMBER		SUCTION CAP ASSEMBLY	FREE	THREADED	POWER		WEIGHT		AIR INLET
					SPEED	SPINDLE	W	hp	kg	lb.	THREAD
					rpm	in					in.
<b>ANGLE GRINDERS</b>											
A	KA11120H5K	615 170 028 0	+	615 396 009 0	12000	HEX	1100	1.50	1.7	3.7	3/8
A	KA11120A5K	615 170 054 0	+	615 396 009 0	12000	M14x2	1100	1.50	1.7	3.7	3/8
A	KA11120A5	615 170 053 0	+	615 396 009 0	12000	M14x2	1100	1.34	1.7	3.7	3/8
A	KA11120B5	615 170 056 0	+	615 396 009 0	12000	3/8"-11F	1100	1.34	1.7	3.7	3/8
A	KA11120A5F	615 170 052 0	+	615 396 009 0	12000	M14x2	1100	1.50	1.7	3.7	3/8
A	KA11120B5F	615 170 055 0	+	615 396 009 0	12000	3/8"-11F	1100	1.50	1.7	3.7	3/8
B	KA11120A4D	615 170 059 0		Supplied with dust extraction casing	12000	M14x2	1100	1.50	1.7	3.7	3/8
<b>ANGLE SANDERS</b>											
C	KA11120A	615 170 051 0	+	615 396 010 0 or 615 396 012 0	12000	M14x2	1100	1.50	1.4	3.1	3/8
C	KA11120B	615 170 239 0	+	615 396 010 0 or 615 396 012 0	12000	3/8"-11F	1100	1.50	1.4	3.1	3/8
C	KA11075A	615 170 061 0	+	615 396 010 0 or 615 396 012 0	7500	M14x2	1000	1.34	1.4	3.1	3/8
C	KA11075B	615 170 062 0	+	615 396 010 0 or 615 396 012 0	7500	3/8"-11F	1000	1.34	1.4	3.1	3/8
C	KA11060A	615 170 063 0	+	615 396 010 0 or 615 396 012 0	6000	M14x2	900	1.21	1.4	3.1	3/8
C	KA11060B	615 170 064 0	+	615 396 010 0 or 615 396 012 0	6000	3/8"-11F	900	1.21	1.4	3.1	3/8



## Dust extraction systems for angle sanders

∅ 127 mm (5") - ∅ 180 mm (7")  
2000 Watts (2.7 hp) - 8500 - 12000 rpm

Supplied with 5/8" threaded spindle only



A



B



C



D

For standard abrasive disc for metallic materials  
∅ 127mm (5")      ∅ 180mm (7")



615 396 387 0

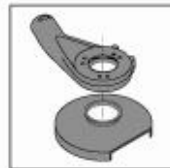

615 396 383 0

Vacuum hose, ID 38 mm (1 1/2")

For standard abrasive disc for non metallic materials  
∅ 127mm (5")      ∅ 180mm (7")

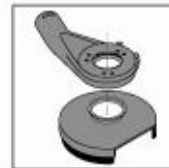

615 396 385 0

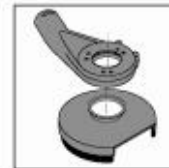

615 396 381 0

Vacuum hose, ID 38 mm (1 1/2")

Caution: comply with the speeds recommended by component and abrasive manufacturers

PIC REF	MODEL	PART NUMBER		SUCTION CAP ASSEMBLY	FREE SPEED	THREADED SPINDLE	POWER		WEIGHT		AIR INLET THREAD
					rpm	in	W	hp	kg	lb.	in.
A	KA20120B	615 170 303 0	+	615 396 387 0	12000	5/8 - 11L	2000	2.7	2.2	4.8	1/2
B	KA20120B	615 170 303 0	+	615 396 385 0	12000	5/8 - 11L	2000	2.7	2.2	4.8	1/2
C	KA20085B	615 170 304 0	+	615 396 383 0	8500	5/8 - 11L	2000	2.7	2.2	4.8	1/2
D	KA20085B	615 170 304 0	+	615 396 381 0	8500	5/8 - 11L	2000	2.7	2.2	4.8	1/2



## Dust extraction systems for vertical & angle sanders

ø 180mm (7")

900 - 1200 Watts (1.21 - 1.61 hp) - 2000 to 6500 rpm

Supplied with M14 & 5/8" threaded spindle only



A



B

For standard abrasive disc for non metallic materials



615 399 364 0



615 396 126 0

For standard abrasive disc for non metallic materials



615 399 365 0



615 396 125 0

Vacuum hose, ID 38mm (1½")



C

Caution: comply with the speeds recommended by component and abrasive manufacturers

PIC REF	MODEL	PART NUMBER		DUST EXTRACTION KIT	FREE SPEED	THREADED SPINDLE	POWER		WEIGHT		AIR INLET THREAD
					rpm	in	W	hp	kg	lb.	in.
<b>VERTICAL SANDER</b>											
A	KL185B	615 170 011 0	+	615 399 364 0 or 615 399 365 0	6500	¾-11f.	1 200	1.61	2.3	5.1	½
<b>ANGLE SANDERS</b>											
B	KA9030A	615 170 096 0	+	615 396 126 0 or 615 396 125 0	3000	M14x2	900	1.21	1.6	3.5	¾
B	KA9030B	615 170 099 0	+	615 396 126 0 or 615 396 125 0	3000	¾-11f.	900	1.21	1.6	3.5	¾
B	KA9020A	615 170 096 0	+	615 396 126 0 or 615 396 125 0	2000	M14x2	900	1.21	1.6	3.5	¾
B	KA9020B	615 170 097 0	+	615 396 126 0 or 615 396 125 0	2000	¾-11f.	900	1.21	1.6	3.5	¾
<b>ANGLE SANDERS for USA Market only (to ANSI B186.1)</b>											
C	KA9030BY	615 170 309 0	+	615 396 126 0 or 615 396 125 0	3000	¾-11f.	900	1.21	1.6	3.5	¾
C	KA9020BY	615 170 308 0	+	615 396 126 0 or 615 396 125 0	2000	¾-11f.	900	1.21	1.6	3.5	¾

